

DATE OF UPDATE:- 03-09-2019

NORTH

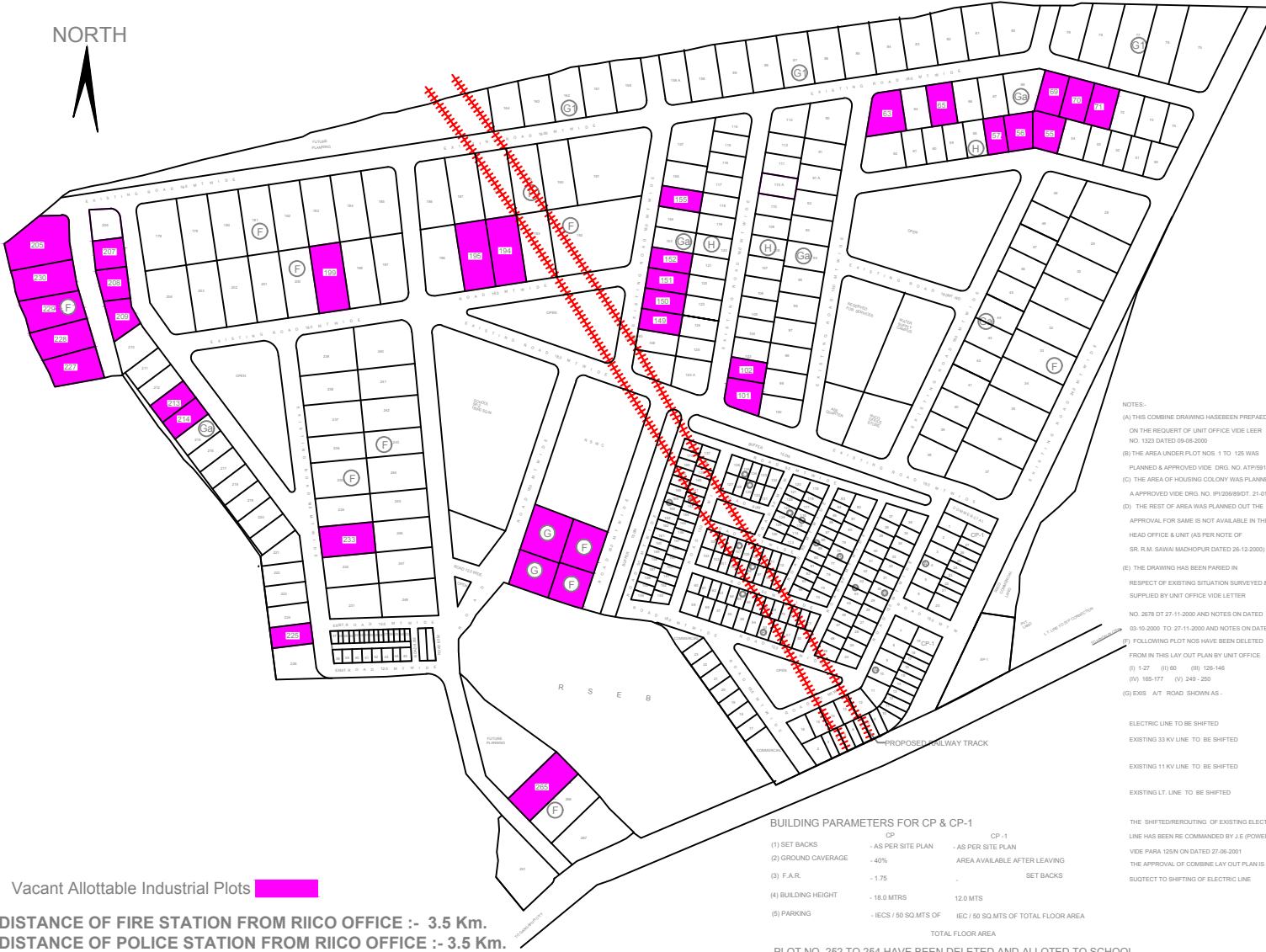

Vacant Allotable Industrial Plots

DISTANCE OF FIRE STATION FROM RIICO OFFICE :- 3.5 Km.
 DISTANCE OF POLICE STATION FROM RIICO OFFICE :- 3.5 Km.

BUILDING PARAMETERS FOR CP & CP-1

	CP	CP -1
(1) SET BACKS	- AS PER SITE PLAN	- AS PER SITE PLAN
(2) GROUND COVERAGE	- 40%	AREA AVAILABLE AFTER LEAVING SET BACKS
(3) F.A.R.	- 1.75	-
(4) BUILDING HEIGHT	- 18.0 MTRS	12.0 MTS
(5) PARKING	- IEC / 50 SQ.MTS OF	IEC / 50 SQ.MTS OF TOTAL FLOOR AREA

TOTAL FLOOR AREA
 PLOT NO. 252 TO 254 HAVE BEEN DELETED AND ALLOTTED TO SCHOOL

NOTES:-

- (A) THIS COMBINE DRAWING HAS BEEN PREPARED ON THE REQUEST OF UNIT OFFICE VIDE LEER NO. 1323 DATED 09-08-2000
- (B) THE AREA UNDER PLOT NOS 1 TO 125 WAS PLANNED & APPROVED VIDE DRG. NO. ATP/99/177
- (C) THE AREA OF HOUSING COLONY WAS PLANNED & APPROVED VIDE DRG. NO. IP/2006/99/DT. 21-01-89
- (D) THE REST OF AREA WAS PLANNED OUT THE APPROVAL FOR SAME IS NOT AVAILABLE IN THE HEAD OFFICE & UNIT (AS PER NOTE OF SR. R.M. SAWAI MADHOPUR DATED 26-12-2000)
- (E) THE DRAWING HAS BEEN PARED IN RESPECT OF EXISTING SITUATION SURVEYED & SUPPLIED BY UNIT OFFICE VIDE LETTER NO. 2678 DT 27-11-2000 AND NOTES ON DATED 03-10-2000 TO 27-11-2000 AND NOTES ON DATED 03-10-2000 TO 27-11-2000 AND NOTES ON DATED 03-10-2000 TO 27-11-2000
- (F) FOLLOWING PLOT NOS HAVE BEEN DELETED FROM THIS LAY OUT PLAN BY UNIT OFFICE (I) 1-27 (II) 60 (III) 126-146 (IV) 166-177 (V) 249-250
- (G) EXIS A/T ROAD SHOWN AS -

- ELECTRIC LINE TO BE SHIFTED
- EXISTING 33 KV LINE TO BE SHIFTED
- EXISTING 11 KV LINE TO BE SHIFTED
- EXISTING LT. LINE TO BE SHIFTED

THE SHIFTED/REROUTING OF EXISTING ELECTRIC LINE HAS BEEN RE COMMANDED BY J.E.(POWER), VIDE PARA 125N ON DATED 27-08-2001
 THE APPROVAL OF COMBINE LAY OUT PLAN IS SUBJECT TO SHIFTING OF ELECTRIC LINE

GANGAPUR

SCHEDULE OF PLOTS

TYPE	SIZE IN METERS	AREA IN SQ.M.	NOS	SET BACKS			REMARKS
				F	S	R	
F	30.0065.0	2000.0	63	5	3	3	3
G	30.0050.0	1500.0	30	5	3	2	3
D1	30.0050.0	1500.0	21	5	3	-	2.5
Ga	25.0040.0	1000.0	47	5	3	-	2.5
H	20.0035.0	700.0	46	4	3	-	2
TOTAL			268				

TOTAL AREA UNDER SCHEME

		H/90	ACRES
PLOTS	..	91.07	..
ROADS	..	31.94	..
OPEN	..	0.09	..
FUTURE PLANNING	..	0.77	..
COMMERCIAL COMPLEX	..	0.75	..
RESIDENTIAL	..	19.80	..
SERVICES	..	0.93	..
RSWC	..	2.55	..

SCHEDULE OF RESIDENTIAL PLOTS

TYPE	SIZE IN METERS	AREA IN SQ.M.	NOS	SET BACKS			REMARKS
				F	S	R	
A	15X25	375.0	23	6	3	3	3
B	12X21	352.0	45	4.5	3	3	3
C	9X18	162.0	103	3	1.5	-	2.5
TOTAL NOS OF PLOTS			171				

LAND USE OF RESIDENTIAL COLONY
 TOTAL AREA UNDER SCHEME:

		19.8	ACRES	100%
PLOTS	..	9.05	..	17.73%
ROAD	..	4.42	..	27.40%
BURER S	..	1.01	..	8.63%
OPEN	..	1.0	..	3.05%
COMMERCIAL COMPLEX	..	2.22	..	1.21%

SCHEDULE OF PLOTS

TYPE	SIZE IN METERS	AREA IN SQ.M.	NOS	SET BACKS			REMARKS
				F	S	R	
CP	25.0040.0	1250.0	1	9	6	3	4.5
CP-1	8.5025.0	212.5	27	4.5	-	-	2.5
TOTAL			28				

COMBINED (REVISED) LAY OUT PLAN OF INDUSTRIAL AREA GANGAPUR CITY (SALODA)
 (PHASE 1st & 2nd)

SCALE:- NTS	DRG.NO.	TPI / 1031 / DATED 02-08-2001
-------------	---------	-------------------------------