

NORTH

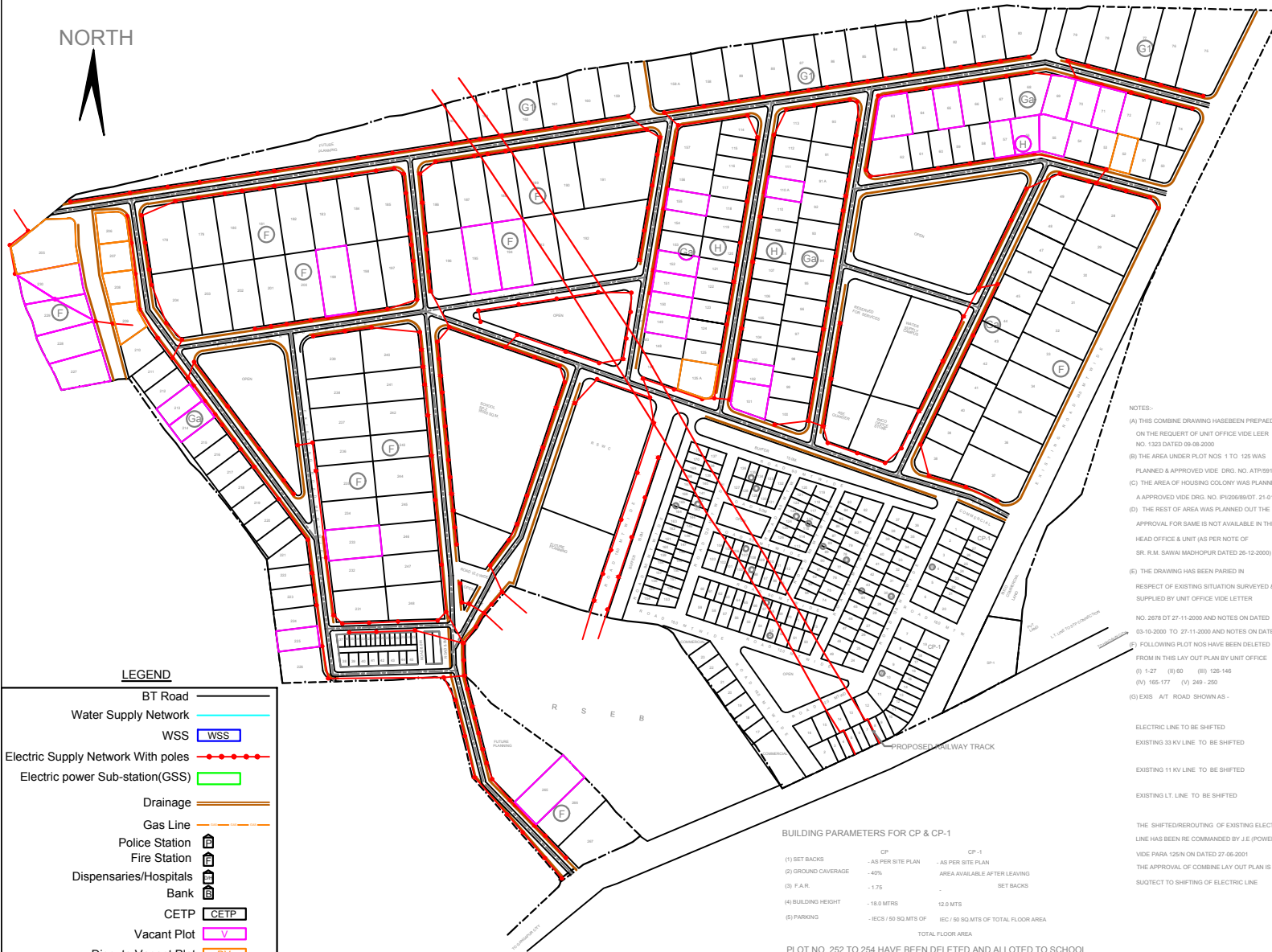

LEGEND

- BT Road
- Water Supply Network
- WSS
- Electric Supply Network With poles
- Electric power Sub-station(GSS)
- Drainage
- Gas Line
- Police Station
- Fire Station
- Dispensaries/Hospitals
- Bank
- CETP
- Vacant Plot
- Dispute Vacant Plot

BUILDING PARAMETERS FOR CP & CP-1

	CP	CP-1
(1) SET BACKS	- AS PER SITE PLAN	- AS PER SITE PLAN
(2) GROUND COVERAGE	- 40%	- AREA AVAILABLE AFTER LEAVING SET BACKS
(3) F.A.R.	- 1.75	-
(4) BUILDING HEIGHT	- 18.0 MTRS	- 12.0 MTRS
(5) PARRING	- IEC / 50 SQ MTS OF	- IEC / 50 SQ MTS OF TOTAL FLOOR AREA

TOTAL FLOOR AREA
PLOT NO. 252 TO 254 HAVE BEEN DELETED AND ALLOTTED TO SCHOOL

NOTES:-

- (A) THIS COMBINE DRAWING HAS BEEN PREPARED ON THE REQUEST OF UNIT OFFICE VIDE LEER NO. 1323 DATED 08-08-2000
- (B) THE AREA UNDER PLOT NOS 1 TO 125 WAS PLANNED & APPROVED VIDE DRG. NO. ATP/89/77
- (C) THE AREA OF HOUSING COLONY WAS PLANNED A APPROVED VIDE DRG. NO. IP/206/88/DT. 21-01-89
- (D) THE REST OF AREA WAS PLANNED OUT THE APPROVAL FOR SAME IS NOT AVAILABLE IN THE HEAD OFFICE & UNIT (AS PER NOTE OF SR. R.M. SAWAI MADHOPUR DATED 26-12-2000)
- (E) THE DRAWING HAS BEEN PARED IN RESPECT OF EXISTING SITUATION SURVEYED & SUPPLIED BY UNIT OFFICE VIDE LETTER NO. 2678 DT 27-11-2000 AND NOTES ON DATED 03-10-2000 TO 27-11-2000 AND NOTES ON DATED 03-10-2000 TO 27-11-2000
- (F) FOLLOWING PLOT NOS HAVE BEEN DELETED FROM IN THIS LAY OUT PLAN BY UNIT OFFICE (i) 1-27 (ii) 80 (iii) 126-148 (iv) 165-177 (v) 249 - 250
- (G) EXIS A/T ROAD SHOWN AS -

- ELECTRIC LINE TO BE SHIFTED
- EXISTING 33 KV LINE TO BE SHIFTED
- EXISTING 11 KV LINE TO BE SHIFTED
- EXISTING LT. LINE TO BE SHIFTED

THE SHIFTERROUTING OF EXISTING ELECTRIC LINE HAS BEEN RE COMMANDED BY J.E (POWER) VIDE PARA 125N ON DATED 27-06-2001
THE APPROVAL OF COMBINE LAY OUT PLAN IS SUGJECT TO SHIFTING OF ELECTRIC LINE

GANGAPUR

SCHEDULE OF PLOTS

TYPE	SIZE IN METERS	AREA IN SQ.M	NOS	SET BACKS				REMARKS	
				F	S	S	R		
F	30.0X65.0	2000.0	63	5	3	3	3		
G	30.0X50.0	1500.0	30	5	3	2	3		
G1	30.0X50.0	1500.0	21	5	3		2.5		
Ga	25.0X40.0	1000.0	47	5	3		2.5		
H	20.0X30.0	700.0	46	4	3		2		
TOTAL			268						

TOTAL AREA UNDER SCHEME

		H.NO	ACRES
PLOTS		91.07	
ROADS		31.94	
OPEN		0.09	
FUTURE PLANNING		0.77	
COMMERCIAL COMPLEX		0.75	
RESIDENTIAL		19.80	
SERVICES		0.93	
RSWC		2.55	

SCHEDULE OF RESIDENTIAL PLOTS

TYPE	SIZE IN METERS	AREA IN SQ.M	NOS	SET BACKS				REMARKS	
				F	S	S	R		
A	19X25	375.0	23	6	3		3		
B	12X21	352.0	45	4.5	3		3		
C	8X18	162.0	103	3	1.5		2.5		
TOTAL NOS OF PLOTS			171						

LAND USE OF RESIDENTIAL COLONY

		ACRES	100%
PLOTS		19.8	100%
ROAD		4.42	27.40%
BUFFER S		1.01	8.62%
OPEN		1.0	3.95%
COMMERCIAL COMPLEX		2.22	1.21%

SCHEDULE OF PLOTS

TYPE	SIZE IN METERS	AREA IN SQ.M	NOS	SET BACKS				REMARKS	
				F	S	S	R		
CP	25.0X40.0	1225.0	1	9	6	3	4.5		
CP-1	8.5X25.0	212.5	27	4.5			2.5		
TOTAL			28						

COMBINED (REVISED) LAY OUT PLAN OF INDUSTRIAL AREA GANGAPUR CITY (SALODA)

(PHASE 1st & 2nd

SCALE:- NTS DRG.NO. TPI / 1031 / DATED 02-08-2001